

### 4.3.1 Provide facilities (amenities) to meet future needs

The term 'amenities' describes facilities such as seats, drink fountains, bins, public toilets, lighting, picnic and BBQ areas which support visitors. Improvements to amenities include assessing gaps in provision, upgrading toilets and improving signage to toilet and picnic areas.

The picnic / BBQ area in Alexandra Park next to the Birrarung (Yarra River) needs redesigning and upgrading to improve access (refer section 4.3.2). There is also the opportunity to provide further picnic and BBQ areas at different locations within the parklands, including Kings Domain South.

Path lighting is important for public safety, amenity and access. There are some areas where improvements to lighting are a priority. These include Alexandra Gardens, especially near the boathouses, and in the access to the Sidney Myer Music Bowl.

Bicycle parking locations and repair stations should be provided in suitable locations within the parklands. Provision of facilities to support recharging motorised scooters and wheelchairs could be investigated in conjunction with the other Land Managers.

#### Master Plan Actions

- Upgrade the depot toilets (at Government House gate) and Alexandra Avenue (S) toilets.
- Determine the optimum size and location for new public toilets at the Alexandra Gardens and provide them. Determine location and provide sewer connection for temporary toilets for events.
- Relocate the toilets currently adjacent to the Sidney Myer Music Bowl to a more suitable location (to be determined during detailed design).
- Review toilets adjacent to The Shrine of Remembrance as part of Kings Domain South detailed design.
- Identify the location and provide a 'changing places' facility to support people with profound disabilities.
- Improve directional signage to public toilets.
- Redesign and upgrade the picnic/BBQ area adjacent to the Birrarung (Yarra River) in Alexandra Park (S).
- Identify suitable locations for new picnic/BBQ areas including in Kings Domain South.
- Assess the location of existing seating, drink fountains, bins, lighting, bike parking and bike repair stations. Develop guidelines and service levels for their type, location and spacing and provide new amenities where required.
- Provide facilities for recharging motorised scooters and wheelchairs.

### 4.3.2 Enhance visitor experience

The highest use of the parklands is unstructured recreation. Unstructured recreation describes activities that are usually non-competitive, spontaneous, informal or social in nature, such as walking, play, picnicking and contemplation.

Understanding the importance of these experiences is important for managing and balancing priorities within the parklands. A balanced approach to enable different activities to occur concurrently or consecutively within the parklands, while not displacing the experiences sought by the majority of users will be sought.

In addition to programming of events and activities, the quality of the visitor experience is influenced by their positive interactions with others, the landscape setting, the amenities that are provided, and their ability to find their way around the parklands. Enhancing the visual amenity and landscape setting of the Domain Parklands will continue to provide the community with relief from the harshness of the urban environment.

The southern section of Alexandra Park, adjacent to the Alexandra Avenue (S) is a popular riverside picnic and BBQ area with a pleasant landscape character. It also has an increasing use by cyclists. A detailed design is a high priority for this area, to improve accessibility of the path network, upgrade the picnic areas, and separate the cyclist movement corridor by creating a dedicated cycle path at road level. This design will also incorporate accessible path links between the Melbourne Gardens and boat landing to support additional transport options to the Melbourne Gardens, and better connect the landscapes (with the Gardens). Other considerations will include planning for tree renewal and other initiatives which link to the draft Melbourne Gardens Master Plan. These projects will be developed with Royal Botanic Gardens Victoria and Parks Victoria.

The Anzac Station (currently under construction) presents an opportunity to create a new entrance to the parklands in Kings Domain South. Accessible paths need to be created to bring visitors to the entrances of the Melbourne Gardens and the Shrine of Remembrance from the station.

A new visitor and nature centre is proposed, to welcome visitors and introduce them to the unique destinations within the parklands. It is envisaged that the nature centre would include an urban forest and ecology education hub, promoting the importance of the urban forest, arboretum, green infrastructure, urban horticulture and nature. The visitor centre component could be curated to introduce themes relating to the evolution and changing character of the parklands. These themes include civic and governance role (Government House), military history and commemoration (Shrine of Remembrance), Aboriginal cultural heritage, science and history (Observatory), botanical (Melbourne Gardens) and the settlement and planning of Melbourne. In consultation with Traditional Owners, information celebrating and acknowledging Aboriginal cultural heritage could also be shared. The proposed National Herbarium of Victoria, which has a critical research and storage function as well as an education and information role, could have elements co-located with the nature centre.

The eastern side of Kings Domain South has a different character, and the detailed design for this area will reflect a range of different 'neighbourhood' uses including paths, seating, picnic tables, fitness equipment and bocce.

The parklands are a rich landscape for play with space, trees to climb, and an interesting variety of places to hide and places to run. Imaginative and unstructured nature play will continue to be encouraged in the parklands. Opportunities and prompts for play could particularly be explored in Kings Domain South.

#### Master Plan Actions

- Prepare a detailed design for Alexandra Park (S). This will include resolution of accessible path locations, upgrading picnic areas and separating cyclist movement corridors.
- Work with the Royal Botanic Gardens Victoria to develop the detailed design to enhance the interface and improve pedestrian links with the Melbourne Gardens.
- Create a new entry to the parklands from the Anzac Station, including accessible paths to entries at the Melbourne Gardens and Shrine of Remembrance.
- Investigate the development of a new visitor and nature centre, in partnership with the Land Managers.
- Investigate opportunities for collaboration with the Royal Botanic Gardens Victoria in the visitor information and education services associated with the proposed new Herbarium within the visitor and nature centre.
- Prepare detailed design for the eastern side of Kings Domain South.
- Introduce programming and prompts for greater play experience in the Domain Parklands.

### 4.3.3 Manage organised activity spaces

There are a number of spaces within the Domain Parklands where organised sporting and recreational activity is supported. These include the skate park, rowing precinct in Alexandra Gardens, the Sidney Myer Music Bowl, Tan Track and Edmund Herring Oval. In addition to these there are a number of cultural and management facilities including La Trobe's Cottage which is managed as a heritage property and the Domain House which is a multi-purpose space supporting engagement with Royal Botanic Gardens Victoria mission and vision. There are two maintenance depots in the parklands.

The Alexandra Gardens are located adjacent to the Birrarung (Yarra River) and are a gateway to the river and a key destination for the parklands. The gardens support a number of activities including skating and provide the premier rowing precinct in the State. The operational needs of rowing include storage and access to the river for launching, and the sport can only occur at this junction of parkland and river. Rowing contributes a vibrant and lively character to this central part of Melbourne. A coordinated and integrated approach to the design and management of these gardens is required in order to achieve the best outcome for all users, now and into the future.

The western side of Kings Domain South currently consists of a beautiful treed landscape and a cluster of buildings and functions that do not relate to each other or fit well in the landscape. There is a need for a detailed design for this area, but it is difficult to be certain of the exact vision for the space as there are a number of changes occurring, such as the development of the Anzac Station.

The dramatic changes (both temporary and permanent) present new opportunities. What is certain is that this will be a new entry to the parklands, and it is important that decisions are made to upgrade the area to support this. The proposal for accessible pathways will open this area of parkland and invite people to discover its beauty.

It will be appropriate to reorganise the built structures in the area as part of this detailed design. What can be anticipated is that the depot buildings that are not heritage listed can be removed. The Domain House will need upgrading to address the parkland and new pathways. A new pedestrian path is also required along Dallas Brooks Drive from Domain Road.

The Edmund Herring Oval is located in Kings Domain South and straddling at its western end the Shrine Reserve. Demand for sports fields in the municipality far exceeds supply, and this demand will continue to increase as the city densifies and the population increases. If the sports ground is to remain, the use must increase. The Edmund Herring Oval could absorb increased use by improved turf management or by converting to a synthetic playing surface. Both approaches will allow more sport to be played on the oval without increasing the footprint of organised sport within the parklands. In the short term it is proposed to continue with an improved grass surface, which is more consistent with the landscape. In the future this may need to be reassessed. The retaining wall needs to be repaired and it is proposed to incorporate terraced seating.

Installation of sports lighting is also required to increase the time available to use the oval. Current technology

ensures lighting is contained within the playing area. It is proposed to install sports lighting which will not spill or impact on the surrounds including the visual significance of the Shrine of Remembrance, the Melbourne Gardens, Melbourne Observatory or local biodiversity. A new pavilion will be required and its location determined in the detailed design for Kings Domain South.

It is acknowledged that decisions in this area may require review in the context of determining the optimum location for the visitor and nature centre (refer section 4.3.2).

With over 2 million people using the Tan Track annually, the "Tan" is an iconic destination for many people who want to develop and maintain their fitness. Providing facilities such as fitness equipment, targeting this user group will support and improve their visitor experience.

Changes in the management of large crowds and the way events are provided have led to an increase in the infrastructure needed at the Sidney Myer Music Bowl.

There is a need to improve the interface between the Sidney Myer Music Bowl and surrounding area of the Kings Domain. This can be done by improving entries, path connections, fencing and where possible concealing built structures in the landscape. Enhancing the natural sound barrier on the perimeter of the Sidney Myer Music Bowl by providing additional tree planting should also be explored.

These improvements will be partnership projects between the City of Melbourne and the Victorian Arts Centre Trust. In the short term the fenced area near the toilets needs to be realigned to improve pedestrian access and circulation, and vehicle entry improvements will be explored.

### Master Plan Actions

- Prepare a detailed design for the Alexandra Gardens:
  - Redesign and upgrade the Riverslide Skate Park and adjacent house and provide new public toilets that are better integrated into the gardens.
  - Improve physical and visual access along the river, provide shade and seating for viewing the river.
  - Improve lighting.
  - Work with the key stakeholders to develop the detailed design for Alexandra Gardens to achieve the best outcome for all users, now and into the future.
  - Prepare design and management solutions to reduce conflict between pedestrians, commuter cyclists and vehicles.
  - Work with the key stakeholders to develop management protocols to reduce vehicle movement behind and in front of boathouses, manage boat trailer use, improve pedestrian safety and relocate waste bins.
  - In partnership with the Victorian Government and Parks Victoria, design and provide a new boat landing at the boathouses, including improved design for the river bank.
- Prepare a detailed design for Kings Domain South. This will include creating a new park entry, new accessible paths from the station, and removing surplus buildings in the depot. Provide a path adjacent to Dallas Brooks Drive from Domain Road.
- Following the Metro Tunnel project, improve the grassed surface of Edmund Herring Oval to increase capacity for use. If use exceeds the capacity of natural turf, convert the oval to a synthetic

surface. Repair the retaining wall incorporating terraced seating.

- Install sports lighting to allow for evening training, that is sensitive to the local biodiversity, Melbourne Gardens, Melbourne Observatory and the Shrine of Remembrance.
- Identify the optimum location and provide a new pavilion / multi-purpose community room adjacent to the Edmund Herring Oval.
- Amend the Crown Land boundary to reflect responsible Land Managers at the Edmund Herring Oval.
- Provide well integrated fitness equipment stations in Kings Domain South and other suitable locations adjacent to the Tan Track.
- Review the service and use of the two maintenance depots to determine if both are still required.

In partnership with the Victorian Arts Centre Trust, proposals relating to the management of the Sidney Myer Music Bowl include:

- Work in partnership with the Victorian Arts Centre Trust to adapt to contemporary trends in use at the Sidney Myer Music Bowl, while also respecting the importance of passive recreation in the adjacent parkland.
- Conduct a strategic review of the interface with the Sidney Myer Music Bowl and Kings Domain.
- Prepare a detailed landscape plan to improve the access to and interface with the Sidney Myer Music Bowl and to improve entries to the venue.

- Work with the Victorian Arts Centre Trust in preparation of a master plan for the Sidney Myer Music Bowl to facilitate improvements and rationalisation of public amenities, toilets, lighting, storage, fencing, access and entrances, and where possible conceal infrastructure in the landscape.
- Explore design and management improvements to vehicle (truck) entry to the 'back of house'.
- Reduce and resolve the need and impact of temporary infrastructure on the landscape.
- Realign the fencing near the toilets to improve pedestrian circulation.
- Refine path layout in Kings Domain to improve access to the Sidney Myer Music Bowl. Improve path lighting for public safety.

#### 4.3.4 Manage events

The Domain Parklands have become increasingly popular for organised events which are held by the City of Melbourne, various Land Managers in the Domain, and external organisations. These events vary in their size, attendance numbers, duration, impact, and the area they use.

Investigation into high impact events in the Domain Parklands and feedback from the community has raised questions about their number and sustainability. Resource demands of parkland reinstatement after events, and effects on parkland ecology and landscape quality is significant.

Unstructured recreation use of the parklands has been affected, particularly as access is restricted when there are extended periods to set up and dismantle events and then reinstate surfaces. In addition to static events within the parklands, fun runs also have an impact on other users, venues in the precinct and residential areas.

Some of these events can have a detrimental effect on those seeking informal passive enjoyment of the Domain Parklands, as normally quiet spaces for informal gatherings can be significantly disrupted by these events.

Coordination for timing of events held across the Domain Parklands including the Sidney Myer Music Bowl, Melbourne Gardens, Shrine of Remembrance and Government House needs to be improved.

#### Master Plan actions

- Establish a Domain Parklands Event Program Group to discuss and coordinate the calendar of events across the Domain Parklands.
- Develop a clear position to balance the use of the parkland for passive and event use and review the events sustainability guidelines.
- Continue to seek a balanced approach to park and event management.
- Investigate moving some fun run start / finish areas to locations where adequate infrastructure is already in place.
- Initiate events curated more specifically for the Domain Parklands.
- Where appropriate, relocate some events to the Sidney Myer Music Bowl.

#### LAND MANAGERS

- Activity spaces(heavy use)
- Activity spaces(moderate use)
- ▨ Activity impacted areas
- ▨ Proposed areas to be upgraded



Major activity areas and impacted surrounding areas within the Domain Parklands

## 4.4 IMPROVE PEOPLE MOVEMENT AND ACCESS



The Domain Parklands are visited by millions of people each year and these numbers are expected to grow. The parklands have many beautiful areas that are easy to find and visit. There are also hidden jewels, providing a discovery experience for visitors.

Supporting access to and within the parklands is important for its role as a welcoming, safe and enjoyable space. Good access provides an invitation to enter the parklands.

The key themes around people movement and access show:

- Access will be improved by establishing a network and hierarchy of paths and identifying and communicating accessible paths of travel.
- Accessible paths of travel will consider journeys and different levels of ability, enabling people to reach destinations as well as meander.
- The network of accessible paths of travel will, where possible, have manageable grades, suitable path surfaces, width and good maintenance.
- Wayfinding is a key ingredient of good access and will include signage, which needs to be in the right place, with the right information, provided in a variety of accessible formats.

### 4.4.1 Improve parklands entrances

Main entrances are located around the perimeter of the Domain Parklands. Most entrances are not formally defined, and it is not clear which part of the parklands you are entering. There are also a number of locations where entrances are not accessible to people with disabilities.

This can make wayfinding for visitors who are not familiar with the parklands problematic. Improving legibility and in some cases moving gateways and paths into the park will facilitate better access to the parklands.

A detailed design is needed to improve the entry and enhanced visitor arrival experience at the Melbourne Gardens, Melbourne Observatory and Shrine of Remembrance hub. This will include changes to circulation and entry for the Melbourne Gardens, consistent with their draft Melbourne Gardens Master Plan. This design will be in partnership with the Royal Botanic Gardens Victoria and the Shrine of Remembrance.

We will continue working with the Royal Botanic Gardens Victoria to improve access to other entries at the Melbourne Gardens, particularly A Gate, C Gate and the proposed new entry (Rivergate entry - Alexandra Avenue).

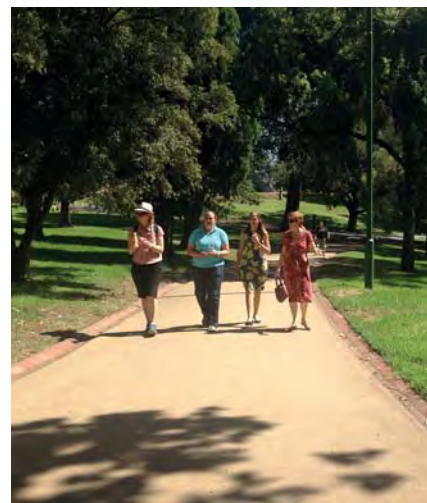

Wide paths on historic alignments

### Master Plan Actions

- Improve entrances:
  - At the major park entry at Linlithgow Avenue and St Kilda Road.
  - At the tram stops along St Kilda Road and Domain Road. Improve access and wayfinding from all tram stops adjacent to the parklands.
  - By designing a new accessible entry from the Coventry Street / Dorcas Street tram stops with the Shrine. Realign and reconstruct the stairs.
  - At the Alexandra Gardens entry at St Kilda Road and the accessible path entry to Queen Victoria Gardens.
  - To the rowing precinct and within the river corridor.
- Work with Royal Botanic Gardens Victoria to improve entries, in particular the Anderson Street entries (A Gate and C Gate).
- Create accessible paths from the river landing entry to connect to a new Melbourne Gardens entry along Alexandra Avenue (S).
- Create a pedestrian plaza and drop off zone at the Melbourne Observatory, to improve visitor arrival experience at these destinations and improve the interface with the Melbourne Gardens and Shrine of Remembrance. The detailed design will be prepared in partnership with the Royal Botanic Gardens Victoria and Shrine of Remembrance.

### 4.4.2 Improve internal pathway networks

The internal path network of the Domain Parklands is extensive. There is a need to review this network to refine its hierarchy, identify accessible paths of travel and ensure the functionality of the paths suits their purpose.

In addition to the terrestrial path network there is opportunity to explore provision of new experiences, such as a tree top walk. Starting at the escarpment north of the Sidney Myer Music Bowl, a tree top walk could be created linking to the Melbourne Gardens, which would give excellent views over the Birrarung (Yarra River) as well as creating an accessible path through challenging topography.

### Master Plan Actions

- Review the path network to identify a hierarchy of paths.
- Identify and promote key routes for accessible paths of travel through the parklands.
- Provide new paths, including new alignments to improve accessibility adjacent to the Birrarung (Yarra River). Create the 'River Walk' as part of this project.
- Identify accessible paths of travel to the Sidney Myer Music Bowl through the parklands. Highlight these paths to patrons with in-ground lighting.
- Investigate provision of a tree top walk and viewing area from the escarpment.

### 4.4.3 Reduce barriers and improve access over roads

There is a road network within the parklands which divides and isolates sections of the parklands. Pedestrian movements and continuity of the parklands can be improved by reducing pedestrian barriers, reimagining road functions and improving access over roads that are to be retained. Pedestrian priority can be reinforced with consistent and clear pedestrian crossings at regular intervals and key locations. Other initiatives include: protected bicycle lanes, shared zones, reducing speed limits, reducing the dominance of the car and narrowing of roads.

The biggest barrier is created by busy Alexandra Avenue (N) between Alexandra Gardens and Queen Victoria Gardens. Opportunities to improve the connection between these sections of parkland in addition to the proposed new pedestrian crossing need to be explored.

Subject to and aligned with anticipated Victorian Government development on the north bank, the location, purpose and need for a pedestrian and bicycle bridge across the Birrarung (Yarra River) should be further explored, and if supported to be funded by the Victorian Government.

Sections 4.4.8 and 4.4.9 describe proposals to support the gradual removal of cars to give the space back to people.

### Master Plan Actions

- Assess current visual and physical barriers and boundaries. Improve links and access by providing consistent and clear pedestrian crossings at regular intervals and key locations.
- Explore opportunities to improve the connection between the Queen Victoria and Alexandra Gardens, such as a land bridge across Alexandra Avenue (N), and ways to reduce the impact of noise on the parkland visitors.
- Provide an additional signalised pedestrian crossing over Alexandra Avenue (N).
- Subject to and aligned with Victorian Government development on the north bank, investigate the location, purpose and need for a new bridge to improve pedestrian and bicycle accessibility across the Birrarung (Yarra River), and if supported, to be funded by the Victorian Government.
- Improve approach to F Gate at Melbourne Gardens at Dallas Brooks Drive and Birdwood Avenue.



Desire lines into the parklands from tram stop along St Kilda Rd

#### 4.4.4 Support access by public transport

Access by public transport to the key destinations within the Domain Parklands is poor. This is due to the location of stops with little or no relationship to destinations in the parklands, lack of attention to the topographical challenges in the parklands, and the type of public transport that currently operates within and immediately abutting the parklands.

Much of this is beyond the control of Council; however, in order to support visitor access and provide alternatives to car travel, there is a need to advocate for substantial improvements to public transport.

The current Metro Tunnel project represents an opportunity to create an accessible link from the new station to the Birdwood Avenue entries to the Shrine of Remembrance and Melbourne Gardens. Council is seeking to influence the design of the station entries to ensure this new link is logical and implementable.

Options for public transport along Birdwood Avenue, including autonomous vehicles should be explored. Options for public transport along the Birrarung (Yarra River) to the Melbourne Gardens should be explored.

#### Master Plan Actions

- Advocate for substantial improvements to public transport to the Domain Parklands and destinations within it.
- Work with the Land Managers and Metro Rail to provide a new accessible pedestrian path from Anzac Station into the parklands and to the Birdwood Avenue entries to the Shrine of Remembrance and Melbourne Gardens.
- Investigate future options for public transport, including autonomous vehicles.
- Work with Parks Victoria to develop a strategic approach to the location and style of boat landings which will support visitor transport to the parklands.

#### 4.4.5 Network approaches to improve cycling routes

The Domain Parklands link at a key convergence within the city's existing bicycle network.

The routes along the Birrarung (Yarra River) corridor (Capital City trail) are heavily used by commuter, recreational cyclists and rowing coaches. There are several points of conflict along the trail, especially in Alexandra Gardens at the boathouses and along Boathouse Drive.

Within the parklands the Capital City trail is narrow, and sight lines are not consistent. This is problematic as the path is also used by high numbers of pedestrians, meandering tourists, people exercising and dog walkers.

With participation in cycling growing and the number of visitors to the parklands increasing, a network-based solution to reduce points of conflict between commuter cyclists and other parklands users is needed. This will be supported by proposals to rethink the ways roads within the parklands are used and regulated (refer section 4.4.8).

#### Master Plan Actions

- Develop a network based solution to the points of conflict between cyclists and other parklands users, consistent with the Bicycle Plan 2016 - 2020.
- Design and implement a dedicated cycle lane following the Birrarung (Yarra River) corridor along or adjacent to Alexandra Avenue (S) from Morell Bridge, to connect to new Linlithgow Avenue and Southbank Boulevard cycle lanes.

#### LEGEND

- ←→ Upgrade cycle link
- Proposed pedestrian crossing
- ⋯ Proposed pedestrian path
- ↔ Investigate location, purpose and need for bridge
- Proposed park promenade
- ↔ Connection improvement (tram to park entrance)
- Proposed drop off/pick up zone



Proposed connections within and around the Domain Parklands

#### 4.4.6 Contemporary way-finding in the Domain Parklands

Currently there is insufficient and poorly placed signage within the parklands. In order to maximise the visitor experience directional information, maps and information to support a visit to the parklands should be easily accessible.

A strategy which reviews the existing signage and identifies how and where to deliver signage and information at key decision points in a visitor's journey is required.

It is also proposed to develop an interpretation plan to include information about history, botanical points of interest, commemoration, monuments in the Kings Domain, the civic role and development of the State identity, and the arboretum.

#### Master Plan Actions

- Using new and existing technologies develop and implement a comprehensive way-finding strategy for the Domain Parklands in consultation with the other Land Managers. This will include:
  - A framework for creating interpretive landscapes and signage with Traditional Owners.
  - A staged approach to removal and installation as well as maintenance guidelines.
  - An interpretation plan to provide information about the Domain Parklands

#### 4.4.7 Create journeys in the Domain Parklands

It is proposed to define and promote a variety of journeys for navigating through the parklands for different levels of ability. This will also enable people to reach destinations via the most direct route or choose to meander and discover something new.

Three major walks have been identified:

- The Domain Parklands Walk, providing the most direct route to the Shrine of Remembrance and Melbourne Gardens, will provide a continuous accessible path of travel mostly within the parklands rather than on the boundary.
- The River Walk presents an opportunity to enhance connection to the Birrarung (Yarra River), while also bringing people to the Melbourne Gardens.
- The Botanical Walk is a journey through the parklands with options for entry to the Melbourne Gardens as well as the main entry to the Shrine of Remembrance.

Many levels of improvement will be required to curate these walks.

In the future new journeys should be curated from the proposed visitor and nature centre.

A new treetop walk, north of the Sidney Myer Music Bowl, could also be investigated.

#### Master Plan Actions

- Define and promote a variety of journeys for navigating through the parklands.
- Develop and promote a Domain Parklands walk, a River Walk and a Botanical Walk.



A wayfinding strategy will guide improvements to support the visitor experience



#### LEGEND

- Proposed Aboriginal Melbourne Walk (refer section 4.2.1)
- Proposed Domain Parklands Walk (primary accessible path)
- Proposed Botanical Walk
- Proposed Tree-top Walk
- Proposed River Walk

New journeys within the Domain Parklands

#### 4.4.8 Rethink the use of existing road space

An extensive road system surrounds and dissects the parklands. The network within the parklands includes Alexandra Avenue, Linlithgow Avenue, Birdwood Avenue and Dallas Brooks Drive.

The roads and parking spaces in the Domain Parklands are used by:

- Parkland users – these are the people that have come to enjoy the parks and gardens and/or visit the various attractions within.
- Non-parkland users – those destined for locations outside the parklands who drive through or those who use the roads as a convenient low cost car park.

The key themes of how the roads are currently used show:

- Most traffic is through traffic.
- There is more than adequate parking for parklands users.

The current traffic activity and parking use detracts from the experience of being within the parklands. Through traffic has increased on all internal roads in the parklands and speeds are not conducive to its setting. It is anticipated that these behaviours and outcomes will compound as the city densifies and the population increases if we do not rethink how we can use these roads.

As the roads occupy a significant area within the parklands they present several opportunities to improve the pedestrian circulation, enhance the parkland visitor experience and improve the environmental function of the parklands.

Rethinking the way we use existing road space anticipates a gradual change to the function of the road. It describes bringing the road into the parkland, to be a place for people rather than a road for cars.

It is proposed to close Linlithgow Avenue (S) to through traffic to better connect these sections of the Kings Domain. This proposal will improve the visitor experience by reducing the impact of cars (of both through traffic and empty parked cars) and return the road space to people.

It is expected that access along Linlithgow Avenue (S) for the horse and carriage operators could continue following road closure as they offer a tourist and recreational experience which can be managed in pedestrianised parkland areas.

The 2016 parking and traffic study highlighted:

- 78 per cent of vehicle movement is through traffic on an average weekday,
- Of the 22 per cent stopping in the parklands many are using the all-day car parking but not visiting the parklands.
- Weekend traffic volumes are lower than weekday traffic volumes.
- Over 1300 car parking spaces are located along parklands roads.
- 63 per cent of car parking is used at the busiest period on an average weekday, 61 per cent of car parking is used on the weekend. Nearly half the weekday parking is by commuters.
- Parking demand is heavily influenced by events within the Domain Parklands or nearby precincts (MCG or Melbourne Olympic Park area).
- Parking occupancies during events can reach very high levels.
- When no events are held, parking occupancy is similar on weekdays and weekends.
- Most of the parking is used for destinations other than the Domain Parklands.

#### Master Plan Actions

- Change the language and appearance of the roads to prioritise pedestrians and the parkland setting.
- Introduce traffic calming measures on internal roads.
- Trial temporary road closures for pedestrian and cycle use, and events on Linlithgow Avenue (S), and other internal roads where possible.
- Reduce speed to 20km per hour on Boathouse Drive.
- Create a new drop off / pick up / turning circle for cars at the east end of the boathouses. Restrict vehicle access along the front and back of the boathouses.
- Establish a new shared zone behind the boathouses, to create a good alternative for cyclists and discourage commuter cycling from the front of the boatsheds in the short term.
- Undertake detailed design to install a bike path at Linlithgow Avenue while retaining vehicle access to Boathouse Drive.
- Remove slip lane between Linlithgow Avenue and Linlithgow Avenue (S). Reinstate park in current road reserve and create accessible path link.
- Investigate changes to Alexandra Park and Alexandra Avenue (S) to create a separated cycle lane.
- Create drop off areas at Marquis of Linlithgow Reserve and at Observatory Gate and Shrine of Remembrance. While providing bus drop off / pick up adjacent to the Shrine, relocate bus parking to the park perimeter on St Kilda and Domain Roads.
- Investigate closure of Linlithgow Avenue (S) to through traffic, to create generous shared path while maintaining access for service vehicles.
- Review locations of bus drop off and bus parking for Melbourne Gardens.
- In the longer term, following completion of the Metro Tunnel project and subject to alternative options for pedestrian access, investigate closure of Birdwood Avenue (N) to through traffic, to create generous shared path while maintaining access for service vehicles.

#### 4.4.9 Car parking – support visitor access while adapting to future trends

We recognise it is important for some people to drive and park at the parklands when visiting. However, parking analysis gives us confidence that car parking can be repurposed in several areas in the parklands.

While parking to visit destinations within the Domain Parklands will be provided, some on-street car parking can be repurposed to improve the amenity, safety, visual experience and better connect the parklands. This will provide space for pedestrian crossings on internal roads, and more dedicated cycle lanes within the parklands.

Changes to parking restrictions in some areas will prioritise park visitors. Changes in the Boathouse Drive area will better support the rowing use in the area.

There will be some change in Alexandra Park and Alexandra Avenue (S) as part of the broader detailed design to upgrade the pedestrian and cyclist movement in this area of parkland.

There is a need to improve accessible parking at key destinations. Explore drop off/pick up options for visitors to the Sidney Myer Music Bowl.

The Shrine of Remembrance Trustees currently permit and manage car parking within the Shrine Reserve for use by their staff, volunteers and invited guests. Alternative solutions should be explored.

#### Master Plan Actions

- Where appropriate and possible, repurpose car parks to reduce the width of road pavements and landscape to improve environmental services and amenity.
- Review and modify parking restrictions to ensure they reflect and support the needs of visitors to the Domain Parklands. Provide greater consistency in application of parking restrictions across the parklands.
- In the short term, change all day parking to 4 hour parking in Linlithgow Avenue (S) to better support park visitors.
- Install pedestrian priority crossings at regular intervals along Linlithgow Avenue (S) Birdwood Avenue, Dallas Brooks Drive and Alexandra Avenue (S).
- Work with the Melbourne Gardens, to improve the pedestrian crossing on Dallas Brookes Drive (N).
- Review location and quantity of drop off bays, bus parking, accessible parking and taxi, food vendor and horse carriage bays. Increase accessible parking at key destinations.
- Repurpose car parking spaces in Linlithgow Avenue to provide dedicated bicycle lanes.
- Modify parking restrictions on St Kilda Road at the Alexandra Gardens entry to support a drop off / pick up area for rowers.
- Work with Land Managers to minimise the parking of cars on the landscape.

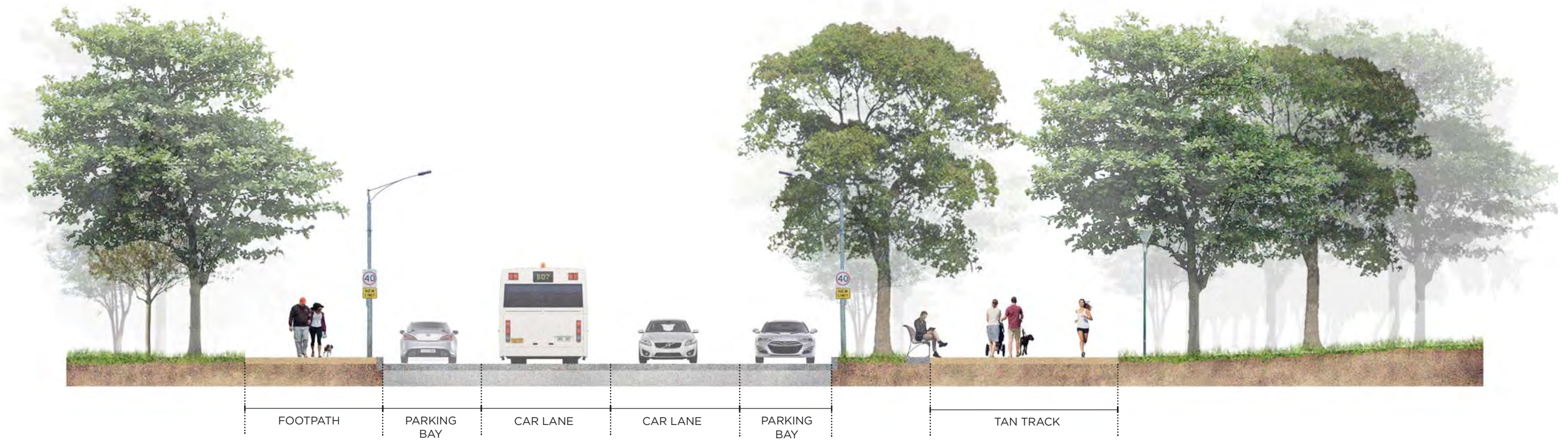

Existing conditions Linlithgow Avenue (north/south)

- wide road reserve
- double side car parking
- generous road carriageway



Linlithgow Avenue  
Road closure during Moomba parade 2018 - supports celebration + activation







*Proposed conditions Linlithgow Avenue (short term)*

- occasional temporary closure for fun runs etc.
- use the road hard stand for events eg. street festivals



*Proposed conditions Linlithgow Avenue (long term)*

- regular temporary closure
- close the road to traffic and maintain for recreational use only

Scenario 02: reducing the road (Linlithgow Avenue north/south)



Proposed conditions Linlithgow Avenue (short term)

- remove some parking
- reduce the traffic speed
- possible water sensitive urban design planting or garden bed extension to allow better tree growth along the existing road edge



Proposed conditions Linlithgow Avenue (long term)

- use the road hard stand for temporary recreation and events, weekend closure or full closure

## 4.5 MANAGEMENT AND PARTNERSHIPS TO BUILD RESILIENCE



Five public Land Managers have responsibility for separate areas of the Domain Parklands. Each Land Manager has particular responsibilities, and has their purpose set by legislation. Collectively they contribute to the function and success of the entire parklands.

- There is opportunity for the Land Managers to collaborate to enhance the broader destination management.
- Potential benefits could include enhanced visitor experience through connected information and journeys to destinations, integrated approaches to management of parkland resources and coordinated event management.
- Collaborative approaches to management will not dilute the individual character and significance of each destination.
- Management responsibility for the Birrarung (Yarra River) rests primarily with Parks Victoria and Melbourne Water. Coordination and collaboration on the management of this interface will continue to be very important.

### 4.5.1 Make one parkland of many unique destinations

The City of Melbourne does not manage all parts of the Domain Parklands. The Melbourne Gardens, Shrine of Remembrance, Sidney Myer Music Bowl and Government House have separate governance and purposes. When combined they provide 123 hectares of parkland. This is significant on many levels.

Uniting these parklands will strengthen the environmental services role for the city, as well as greatly improve the visitor experience of the place.

#### Master Plan Actions

- In addition to the proposals to improve pedestrian access and environmental services, 'making one parkland of many unique destinations' will be strengthened by establishing an agreed vision for the Domain Parklands with all Land Managers.

*This action recognises that there are distinct organisational vision and profiles for each Land Manager (and their organisation), as well as specific legislation directing their purpose.*

### 4.5.2 Create a framework for priorities and decision-making

This master plan has been developed to guide future management of the Domain Parklands and will provide the framework for priorities and decision-making.

It is clear that the broader environmental service function of the parklands as a whole, and the critical role parkland plays in the health of the community, needs to be a high priority in decision-making. When any decision is made, the effect of this decision on the environmental service function should be an important consideration.

#### Master Plan Actions

- Develop an implementation plan for the master plan which clearly articulates short, medium and long term actions to logically implement the master plan actions.
- Review and update the master plan 10 years after it is endorsed by Council.

### 4.5.3 Commitment to future management and collaboration

It is proposed to initiate regular meetings of the Land Manager executives to allow regular communication and coordination across the parklands. In addition to the four Land Managers, Council will engage with external entities whose activities may impact and influence the parklands (e.g. Parks Victoria, Metro Rail, Vic Roads).

The sharing of information, greater communication and a better understanding of Land Manager and visitor requirements to each destination will assist in co-ordinated decision making, facilities provision and management actions.

#### Master Plan Actions

- Initiate regular meetings of the Land Manager Executives.
- Introduce regular meetings for operational staff to examine visitor requirements to inform planning for improved services.
- Explore shared use provision of some visitor services.

### 4.5.4 Manage uses in the Crown reserves managed by the City of Melbourne

The individual Reserves which make up the Domain Parklands are all permanently reserved Crown Land, set aside for specific purposes. Most recreational activities can occur within these broad purposes. However, there are times where applications are made for activities or events which are inconsistent with the purpose of the reservation.

*The Crown Land (Reserves) Act 1978* sets out processes for the management of inconsistent uses within the reservation. This intensive process is used for activities with a greater impact on the parklands. Where an activity has a lesser impact on the park, Council manages the application using the local law permit process.

The practice provides appropriate levels of approval or scrutiny, which enable hundreds of events to occur, while ensuring thoughtful decisions are made on events of greater impact. This forms part of the important protection of parkland for future generations.

#### Master Plan Actions

- Continue and improve (as required) the management practices developed by the City of Melbourne with DELWP to assess uses inconsistent with the parklands reservations.

### 4.5.5 Reduce the impact of services

There are regular and frequent requests by utility service providers, government projects, and activity organisers to install permanent or temporary services in the Domain Parklands.

There is a current request for a permanent telecommunications tower to be installed in a higher location in the parklands to support the increased demand for services from major events in the precinct. Temporary towers have been used to date.

Utility service installations impact on visual amenity, usability, recreational value, and environmental service function. It is proposed to protect the landscape character of the parklands by avoiding new utility service structures or expansion of existing structures.

As stated in the Master Plan values, fundamental to all the values is the principle that there be no net loss of parkland and that future change should bring positive benefits to the Domain Parklands.

#### Master Plan Actions

- Protect the landscape character of the Domain Parklands by avoiding new or expansion of existing above ground utility structures associated with electricity, gas or telecommunications.
- Seek opportunities to work with Land Managers to reduce duplication of services, ensure infrastructure is discrete and consolidated.
- Address the negative visual impact of service cabinets on St Kilda Road boundary of Queen Victoria Gardens and other services in the parklands.
- Review the potential to provide more permanent telecommunications support within existing infrastructure.

EXTERNAL LAND MANAGERS



PARKLANDS LAND MANAGERS

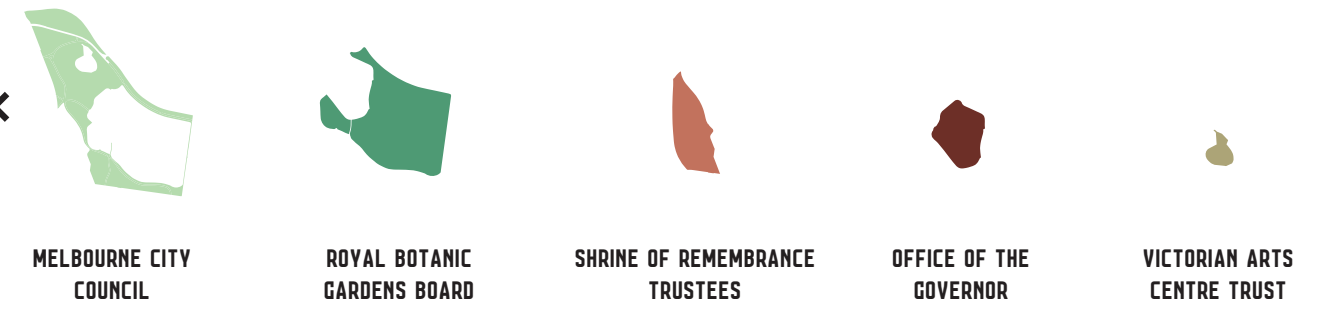

SHARED VISION  
'ONE DOMAIN'

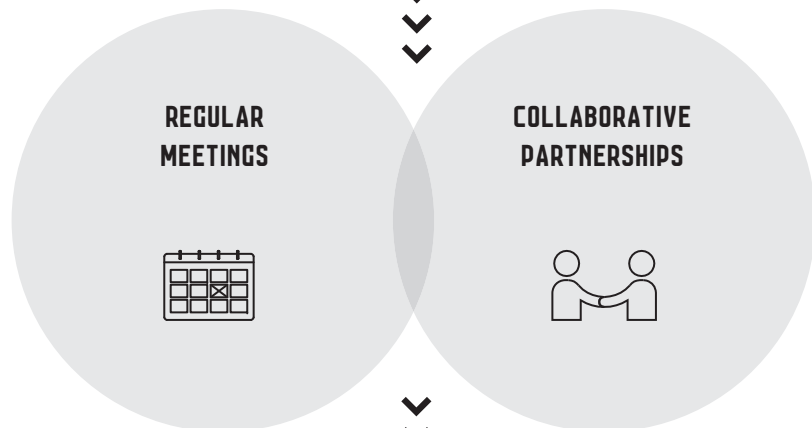

MANAGEMENT & PARTNERSHIP  
MASTERPLAN OUTCOMES

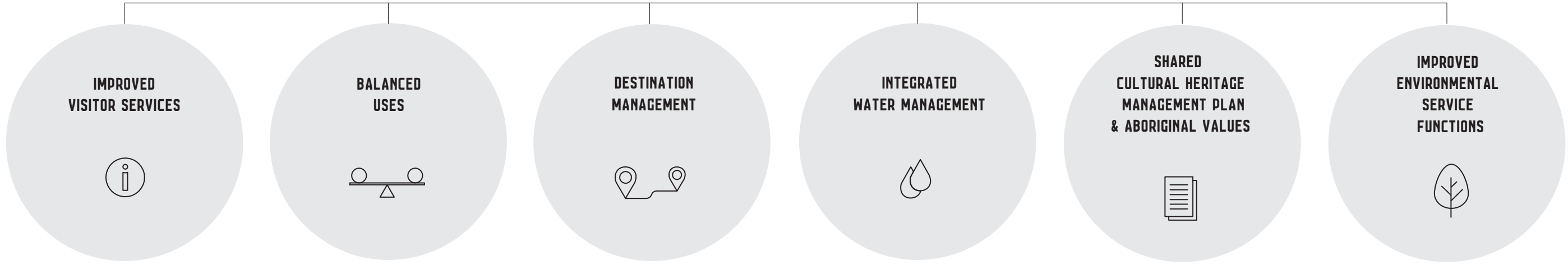

# 5. DOMAIN PARKLANDS PRECINCT PLANS

Section five shows the Domain Parklands divided into five precincts. The plans explain a summary of proposed upgrades to the areas and the key precinct actions.

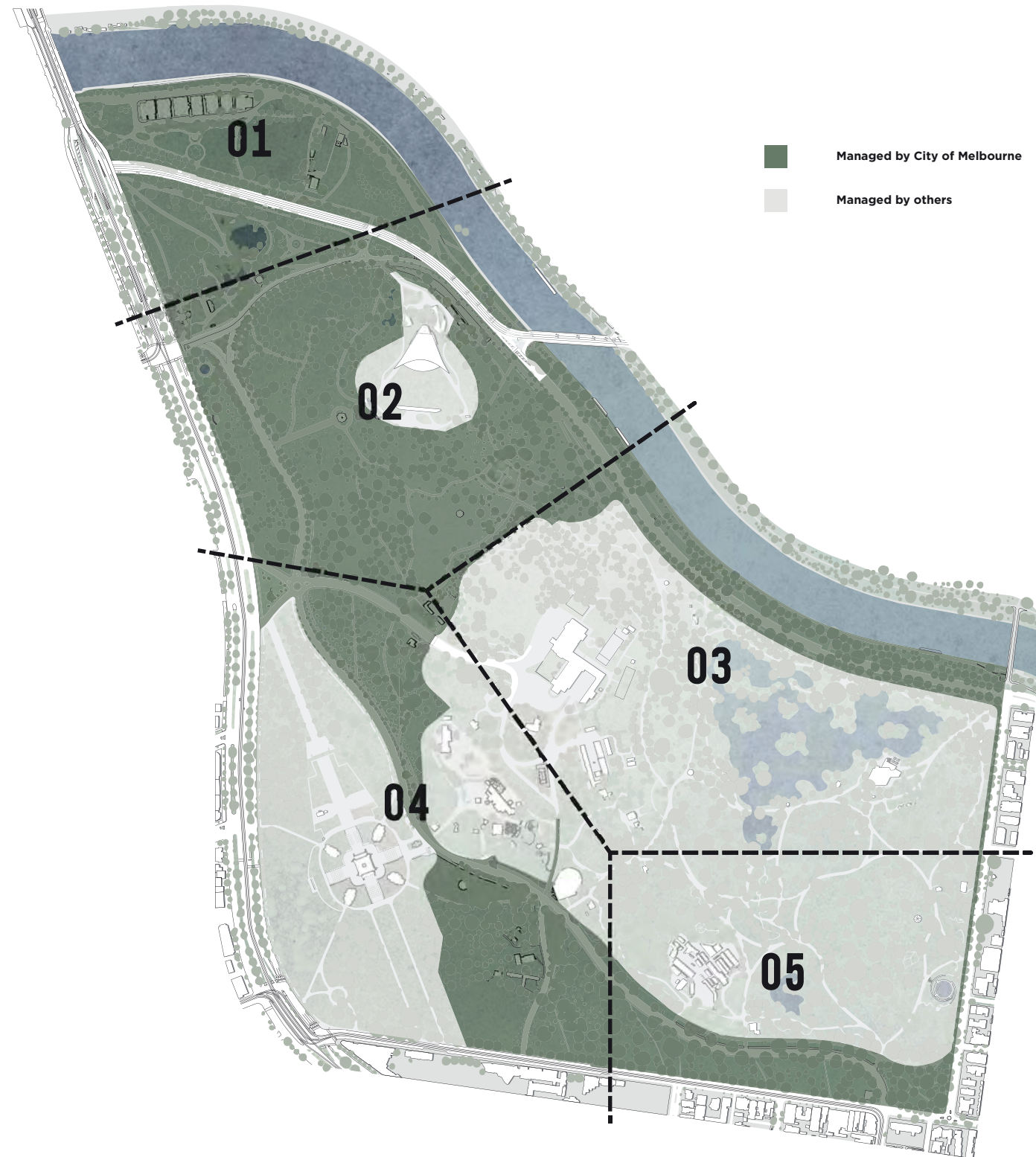

# 5.1 PRECINCT 01 - ALEXANDRA AND QUEEN VICTORIA GARDENS

**SUMMARY OF MAJOR ACTIONS INCLUDE:**

- Prepare detailed design for Alexandra Gardens
- Determine optimum size and location for new public toilets at the Alexandra Gardens and provide them
- Prepare design and management solutions to reduce conflict between pedestrians, commuter cyclists and vehicles
- Establish a new shared zone behind the boathouses, to create a good alternative for cyclists and discourage commuter cycling from the front of the boathouses
- Reduce vehicle movement in front and behind boathouses
- Manage boat trailer parking and remove non-essential car parking behind boathouses
- Improve waste management in the precinct
- Improve physical and visual access along the river. Investigate ways to improve views to the river
- Introduce new native planting adjacent to the Birrarung, extent subject to future design
- Improve lighting

In partnership with Victorian Government and Parks Victoria, design and provide new rowing landing and improve design for river bank

Modify parking restrictions on St Kilda Road to support drop off/pick up of rowers. Improve path lighting to boathouses









Investigate future land bridge at high point to extend pedestrian link over Alexandra Avenue

Upgrade entry to include accessible path

New accessible connection into park from tram stop

Consolidate service cabinets in single cover

Build new signalised pedestrian crossing and review associated pedestrian movement, including locations of path connections

-  Boathouse precinct
-  Skatepark upgrade
-  New river edge planting
-  New native understorey planting
-  New low buffer planting
-  New path connection
-  New DDA compliant path
-  Potential future links

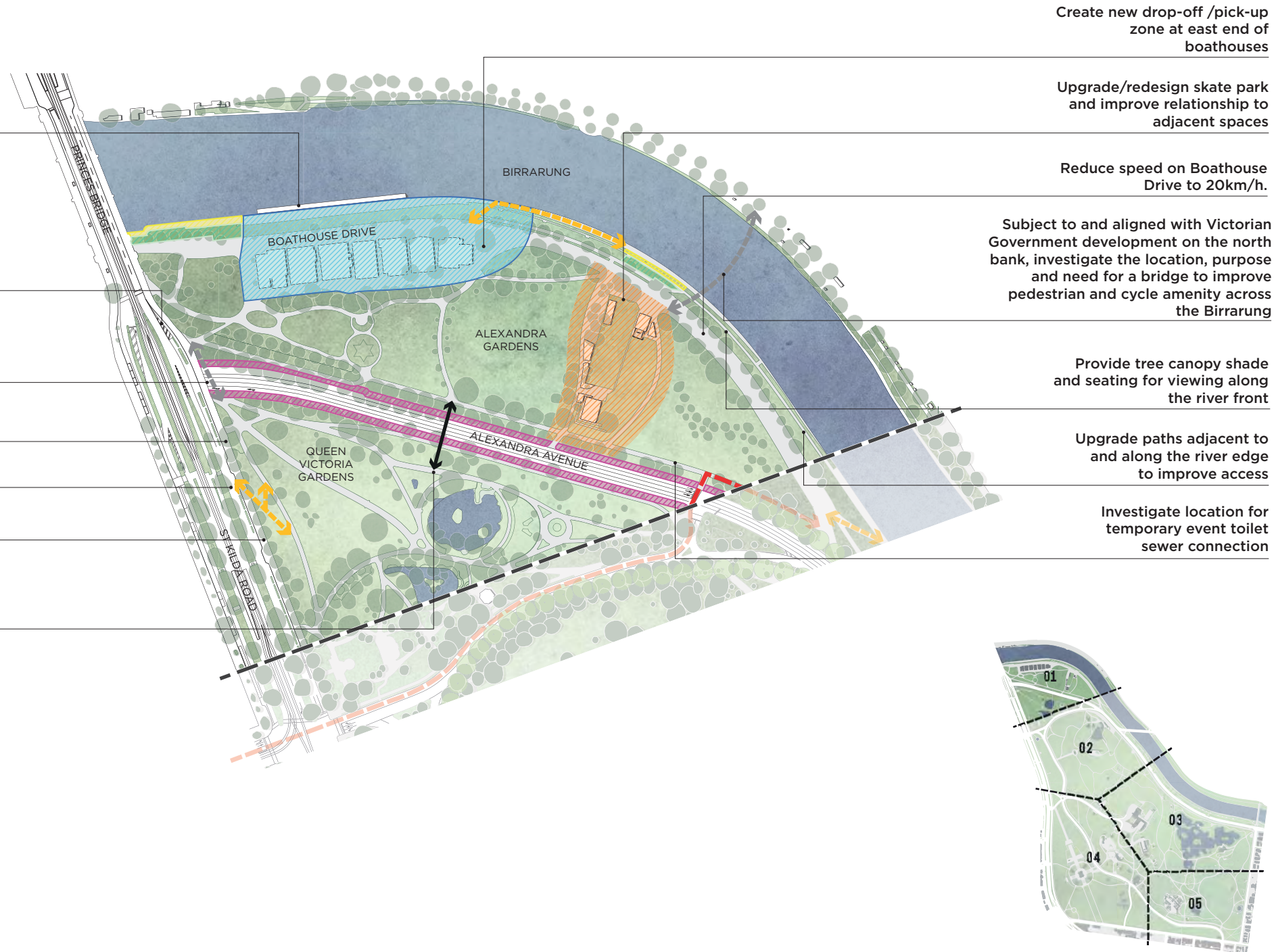

Create new drop-off /pick-up zone at east end of boathouses

Upgrade/redesign skate park and improve relationship to adjacent spaces

Reduce speed on Boathouse Drive to 20km/h.

Subject to and aligned with Victorian Government development on the north bank, investigate the location, purpose and need for a bridge to improve pedestrian and cycle amenity across the Birrarung

Provide tree canopy shade and seating for viewing along the river front

Upgrade paths adjacent to and along the river edge to improve access

Investigate location for temporary event toilet sewer connection

# 5.2 PRECINCT 02 - KINGS DOMAIN

Install bike lane, retain vehicle access and improve pedestrian access at slip lane

Create new landscape setting for Kings Domain Resting Place

Repurpose car parking spaces in Linlithgow Avenue to provide dedicated bicycle lanes

Remove slip lane, create accessible path and upgrade rockery

Define entry at corner. Upgrade seating and landscape setting at fountain and make path accessible

Investigate access improvements to Police Memorial

Remove all day parking along Linlithgow Avenue. Convert to 4 hour parking in the short term

Create new accessible connection from tram stop crossing to connect with King George V avenue entry

Trial temporary road closures at Linlithgow Avenue (S) and investigate closure to through traffic

Develop a design for Tom's Block that enhances the native landscape along St Kilda Road frontage

-  New river edge planting
-  Rock embankment stabilisation planting
-  New native understorey planting
-  Decorative floral border planting
-  Remove slip lane
-  Melbourne Gardens landscape interface
-  New pedestrian crossing
-  Extent of Arts Centre land area
-  New path connection
-  New DDA compliant path
-  Investigate a tree top walk
-  New cycle path
-  New avenue trees  
(Trees to be replaced in stages and as required. Works to be co-ordinated with renewal projects subject to future detailed design)



Work with Victorian Arts Centre to design and implement improvements to back of house (Sidney Myer Music Bowl) including vehicle entry

Upgrade to provide accessible paths

Trim back Henley landing and upgrade remaining

Entrance ridge line path to take advantage of high point and city views

Relocate the toilets adjacent to the Sidney Myer Music Bowl to a more suitable location

Work with Victorian Arts Centre Trust to improve integration of Sidney Myer Music Bowl into Kings Domain

New bike path connecting Morell Bridge to Southbank Boulevard

Upgrade paths along river edge to improve accessibility

Upgrade picnic and barbecue areas in Alexandra Park (S) and improve path links. (Refer notes in Precinct 3)

Work with Royal Botanic Gardens Victoria to review entry, re-align paths and extend botanical character towards park perimeter. (Continue Precinct 03)

Investigate a tree top walk

Improve lighting

**SUMMARY OF MAJOR ACTIONS INCLUDE:**

- Improve pedestrian access and circulation. Connect pedestrian crossings, entries and paths. Improve DDA access into and within the park and along the Birrarung edge
- Undertake detailed design to install a bike path at Linlithgow Avenue while retaining vehicle access to Boathouse Drive
- Design and implement a dedicated cycle lane following the Birrarung corridor from Morell Bridge, through Linlithgow Avenue to connect to Southbank Boulevard cycle lanes
- Work with the Victorian Arts Centre Trust to prepare a master plan to upgrade public amenities, toilets, lighting, storage, fencing, access and entrances to the Sydney Myer Music Bowl. Where possible conceal infrastructure in the landscape
- Upgrade area to north of Sidney Myer Music Bowl to improve access. Starting at the escarpment investigate provision of a ridge line and a tree top walk to create an accessible path to the Melbourne Gardens and take advantage of views from the high points
- Establish a stronger hierarchy of paths
- Prepare a detailed landscape design for Tom's Block. Review and improve accessibility in Tom's Block
- Relocate the toilets adjacent to the Sidney Myer Music Bowl to a more suitable location
- Introduce new native planting adjacent to the Birrarung, extent subject to future design



# 5.3 PRECINCT 03 - YARRA FRONTAGE AND GOVERNMENT HOUSE

**SUMMARY OF MAJOR ACTIONS INCLUDE:**

- Prepare a detailed design for Alexandra Park (S). This will include resolution of accessible path locations, upgrades to picnic and barbecue areas and separate cyclist movement corridors
- Improve links to Richmond Railway Station
- Introduce new native planting adjacent to the Birrarung, extent subject to future design

-  New dedicated bus parking
-  Melbourne Gardens landscape interface
-  New river edge planting
-  New native understorey planting
-  Enhance link to Richmond Station
-  New DDA compliant path
-  New cycle path
-  New avenue trees
-  New pedestrian crossing

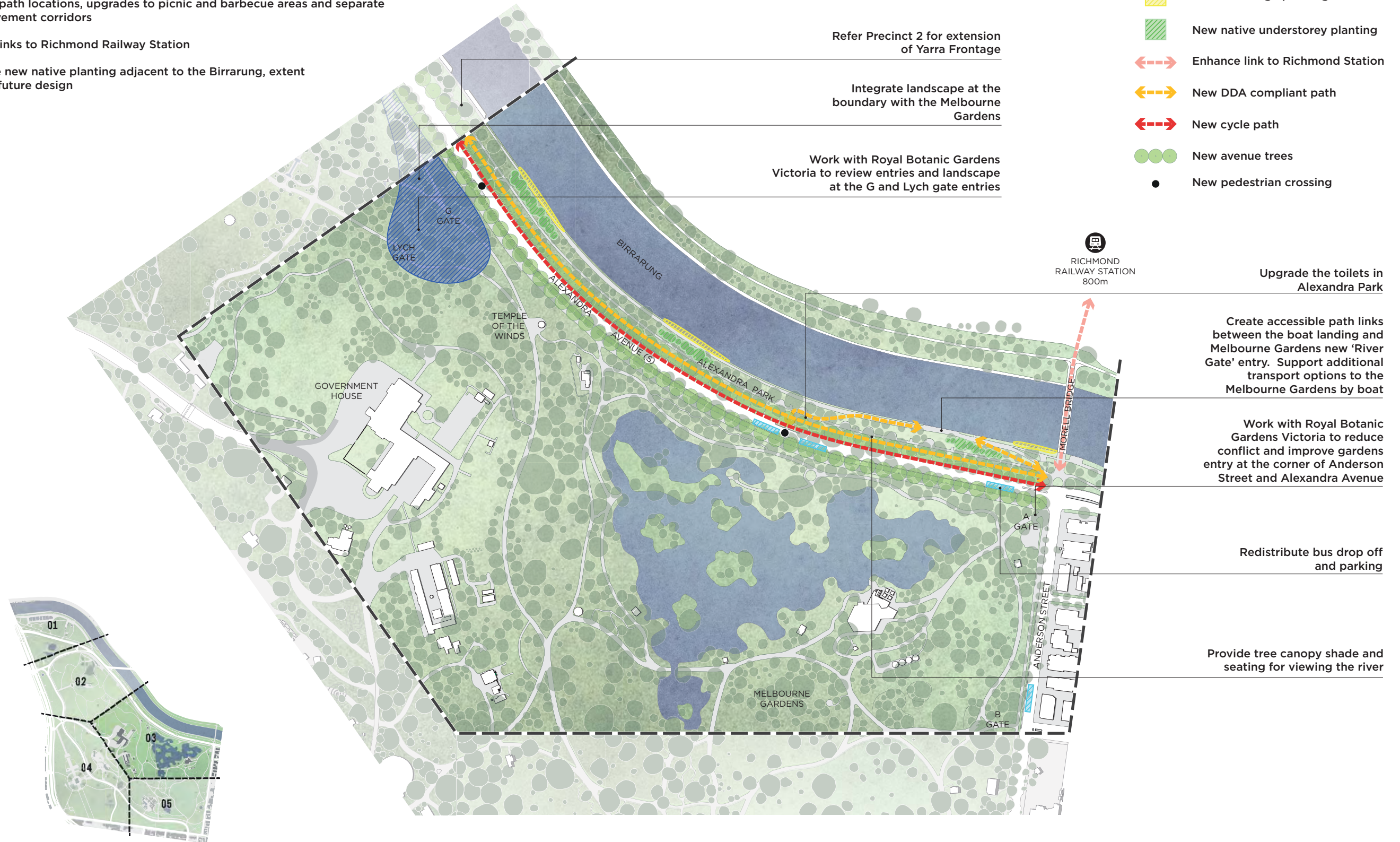



# 5.4 PRECINCT 04 - VISITOR PRECINCT

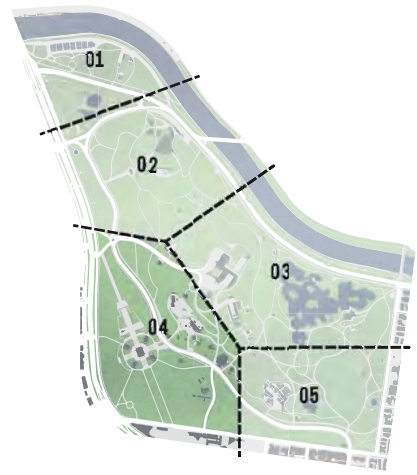

Create new bus/tourist coach drop off and stopping zone at the northern ceremonial entry of the Shrine Reserve

Improve pedestrian connections from the St Kilda Road tram stop into the parklands. Work with the Shrine of Remembrance Trustees on future plans to fulfil historic design intent of the western axial approach

Create pedestrian priority precinct and dropoff zone

Proposed Anzac Station entry

- Birdwood Avenue
- Pedestrian priority precinct
- Access improvements
- Potential Nature and Science Precinct
- Kings Domain South Precinct (west)
- Kings Domain South Precinct (east)
- New DDA compliant path
- New path connection
- New pedestrian crossing



**SUMMARY OF MAJOR ACTIONS INCLUDE:**

- Prepare a detailed design for Kings Domain South Precinct (west). This will include creating a new park entry, new accessible paths from the station and removing surplus buildings at the depot. Also including re-instatement of Edmund Herring Oval post Metro Tunnel works, integration of buildings into landscape (Domain House, Depot, pavilion, La Trobe's Cottage)
- Create and enhance a new park entry from Anzac Station into the Domain Parklands
- Work with Royal Botanic Gardens Victoria and Shrine of Remembrance Trustees to create wayfinding signage to orientate visitors to entry points
- In the longer term, following completion of the Metro Tunnel project and subject to alternative options for pedestrian access, investigate closure of Birdwood Avenue (N) to through traffic

Work with the Royal Botanic Gardens Victoria to develop the detailed design to enhance interface and improve pedestrian links within the Melbourne Gardens

Explore opportunities for co-location of facilities as part of potential Nature Science Precinct

Improve pedestrian safety at existing zebra crossing over Dallas Brooks Drive north of Birdwood Avenue

Provide a new DDA-compliant footpath for pedestrians connecting Anzac Station to Shrine of Remembrance and Melbourne Gardens entries at Birdwood Avenue (indicative alignment only)

Review access in this area as change occurs with the new park entry and Melbourne Gardens Master Plan

Following the Metro Tunnel project, reinstate the Edmund Herring Oval with upgraded turf surface and sports lighting

Investigate the location and provide new pavilion/multi-purpose community room adjacent to the Edmund Herring Oval

Kings Domain Precinct South (east) refer notes in Precinct 5

# 5.5 PRECINCT 05 - KINGS DOMAIN SOUTH

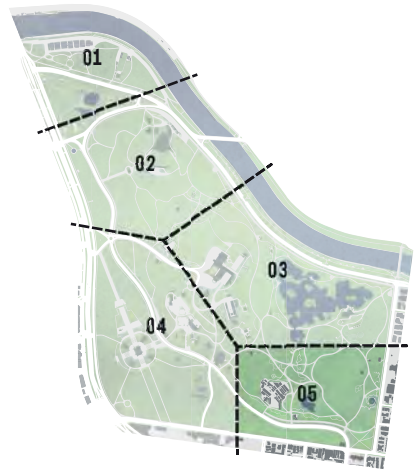

**SUMMARY OF MAJOR ACTIONS INCLUDE:**

- Prepare a detailed design for the eastern side of Kings Domain South. This will include design of neighbourhood settings for picnic tables, BBQs and paths. It will also include diversifying tree species, additional planting and well integrated fitness equipment along Birdwood Avenue
- Investigate and create new granitic sand paths





# 6.1 INDICATIVE PHASING FOR MASTER PLAN IMPLEMENTATION

The following section outlines the indicative phasing that is recommended to implement the master plan.

The priorities have been developed with consideration of funding, technical constraints and coordination with the Melbourne Metro Tunnel Project.

It is proposed that an implementation plan be prepared to support the process. The implementation plan will identify project scope, stakeholders, and indicative costing. Management initiatives will also be documented, with project leads and target dates proposed.

Many identified projects will require detailed design. This term has been used in the master plan to refer to development of a schematic design, design development and contract documentation.

- Projects by City of Melbourne
- Projects by others
- Projects by City of Melbourne in collaboration with other land managers

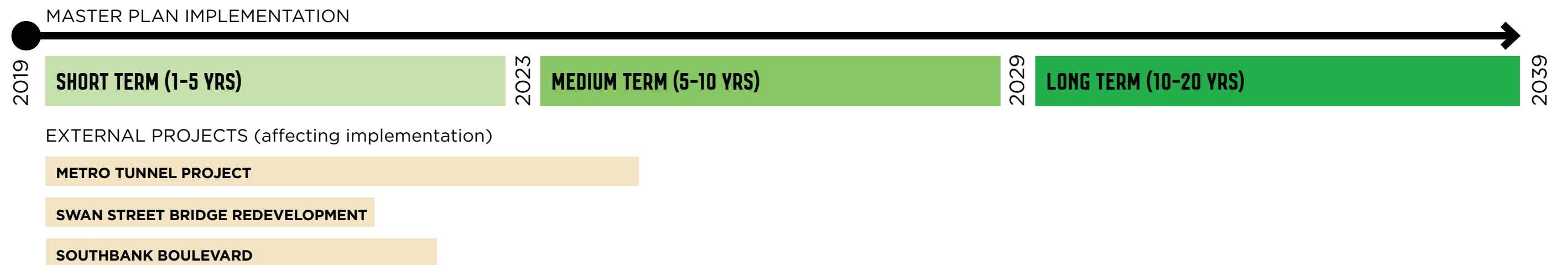

## 6.2 REVIEW OF THE PLAN

Although the vision and broad direction of the Domain Parklands Master Plan should be ongoing, the specific recommendations of master plans may require additional review after 10 years. This should enable major influences on the area, such as the Melbourne Metro Tunnel project, to be properly reflected.

While the Domain Parklands Master Plan is a 20 year plan, it is proposed that a minor review be prepared for Council endorsement in 2028.

## 6.3 MASTER PLAN IMPLEMENTATION SUMMARY

### Nurture a diverse landscape and parkland ecology

Initiatives	Action or Recommendation	Indicative timeline		
		Short	Medium	Long
<b>Elevate horticultural complexity and management</b>	Implement City of Melbourne Eco-City strategies while retaining landscape design elements that have been assessed as having primary conservation significance.	Ongoing		
	Develop and implement a management plan and guiding principles that facilitates horticultural excellence for planting styles, locations and maintenance regimes for the parklands.			
	<b>High priority initiative</b> Strategically introduce native plant palettes in key areas including the Birrarung edge.			
	As part of the detailed designs for Kings Domain South, Kings Domain (Tom's Block) and Alexandra Park, improve landscape character and planting diversity.			
<b>Support a healthy ecosystem</b>	Implement the principles of Urban Forest Strategy and Nature in the City Strategy to improve biodiversity and urban ecology.	Ongoing		
	Partner with Land Managers on initiatives to improve biodiversity outcomes, integrate approaches to water management and advance the arboretum.	Ongoing		
<b>Manage a City Arboretum</b>	Develop and manage the city Arboretum in partnership with the Royal Botanic Gardens Victoria.	Ongoing		
	Recommend funding for program delivery of science, research and education for the arboretum.			
	Develop a detailed tree planting and maintenance plan and collections policy for the arboretum.			
<b>Manage soil and water</b>	Continue innovative approaches to soil management.	Ongoing		
	Continue to work toward integrated water management	Ongoing		
	Investigate and recommend investment in alternative water supply systems in partnership with Land Managers to achieve a 50 per cent target of all irrigation water used in the parkland being from a non-potable source.			

### Acknowledge history and cultural heritage

Initiatives	Action or Recommendation	Indicative timeline		
		Short	Medium	Long
<b>Respect and celebrate Aboriginal cultural heritage</b>	Work collaboratively with the Traditional Owner groups to build a stronger story of the Aboriginal connection to the area of the Domain Parklands, Birrarung and river banks.	Ongoing		
	Commission further research of historical data from primary sources and the Lower Yarra landscape's cultural values, with a focus on the Domain Parklands.			
	<b>High priority initiative</b> Explore and strengthen the link to Tromgin (Indigenous local gathering site) and along the Birrarung, in collaboration with Traditional Owners and Royal Botanic Gardens Victoria.			
	Develop a self-guided Melbourne walk in collaboration with Traditional Owners and Royal Botanic Gardens Victoria.			
	Working with all the Land Managers and Traditional Owners, develop a joint Cultural Heritage Management Plan to guide the management of the place.			
	Explore renaming places within the parklands to recognise Aboriginal history and culture.			
<b>Reflect cultural values and historical significance</b>	Promote an increase in community understanding and recognition of cultural heritage. Increase the public visibility of the history of the parklands through information and interpretation.	Ongoing		
	Continue to maintain and restore the unique parts of the cultural collection.	Ongoing		
	Prepare a Heritage Management Plan for the Domain Parklands National Heritage place.			
<b>Manage memorials in the Domain Parklands</b>	Requests for future memorialisation, other than within the Shrine Reserve, are only considered if in keeping with the <i>Plaques and Memorials Policy (2016)</i> .	Ongoing		
	No additional large memorials or monuments, unless replacing existing ones, be permitted within areas of the Domain Parklands managed by the City of Melbourne.	Ongoing		

### Support exceptional visitor experience

Initiatives	Action or Recommendation	Indicative timeline		
		Short	Medium	Long
<b>Provide facilities ('Amenities') to meet future needs</b>	Upgrade the depot toilets (at Government House gate) and Alexandra Avenue (S) toilets.			
	Determine the optimum size and location for new public toilets at the Alexandra Gardens and provide them. Determine location and provide sewer connection for temporary toilets for events.			
	Relocate the toilets currently adjacent to the Sidney Myer Music Bowl to a more suitable location (to be determined during detailed design).			
	Review toilets adjacent to Shrine as part of Kings Domain South detailed design.			
	Identify the location and provide a 'changing places' facility to support people with profound disabilities.			
	Improve directional signage to public toilets.			
	Redesign and upgrade the picnic/BBQ area adjacent to the Birrarung in Alexandra Park (S).			
	Identify suitable locations for new picnic/BBQ areas including in Kings Domain South.			
	Assess the location of existing seating, drink fountains, bins, lighting, bike parking and bike repair stations. Develop guidelines and service levels for their type, location and spacing and provide new amenities where required.			
	Provide facilities for recharging motorised scooters and wheelchairs.			
<b>Enhance visitor experience</b>	Prepare a detailed design for Alexandra Park (S). This will include resolution of accessible path locations, upgrading picnic areas and separating cyclist movement corridors			
	Work with the Royal Botanic Gardens Victoria to develop the detailed design to enhance the interface and improve pedestrian links with the Melbourne Gardens.			
	Create a new entry to the parklands from the Anzac station, including accessible paths to entries at the Melbourne Gardens and Shrine of Remembrance.			
	Investigate the development of a new visitor and nature centre, in partnership with the Land Managers.			
	Investigate opportunities for collaboration with the Royal Botanic Gardens Victoria in the visitor information and education services associated with the proposed new Herbarium within the visitor and nature centre.			
	Prepare detailed design for the eastern side of Kings Domain South.			
<b>Manage organised activity spaces</b>	Introduce programming and prompts for greater play experiences in the Domain Parklands.			
	Prepare a detailed design for the Alexandra Gardens.			
	<b>High priority initiative</b> Redesign and upgrade the Riverside Skate Park and adjacent Former Gardener's Cottage and provide new public toilets that are better integrated into the gardens.			
	Improve physical and visual access along the river, provide shade and seating for viewing the river.			
	Improve lighting			
	Prepare design and management solution to reduce conflict between pedestrians, commuter cyclists and vehicles.			
	Work with the rowing clubs to develop the detailed design for Alexandra Gardens to achieve the best outcome for all users, now and into the future.			
	Work with the rowing clubs to establish management protocols to reduce vehicle movement behind and in front of boathouses, manage boat trailer use, improve pedestrian safety, and relocate waste bins.			
	In partnership with the Victorian Government and Parks Victoria, design and provide a new boat landing at the boathouses, including improved design for the Birrarung (Yarra River) bank.			
	Prepare a detailed design for Kings Domain South. This will include creating a new park entry, new accessible paths from the station, and removing surplus buildings in the depot. Provide a pedestrian path adjacent to Dallas Brooks Drive from Domain Road.			
	Following the Metro Tunnel project, improve the grassed surface of Edmund Herring Oval to increase capacity for use. If use exceeds the capacity of natural turf, convert the oval to a synthetic surface. Repair the retaining wall and incorporate terraced seating.			
	Install sports lighting to allow for evening training that is sensitive to local biodiversity, Melbourne Gardens, Melbourne Observatory and the Shrine of Remembrance.			
	Identify the optimum location and provide a new pavilion / multi-purpose community room adjacent to the Edmund Herring Oval			
Amend the Crown Land boundary to reflect responsible Land Managers at the Edmund Herring Oval.				
Provide well integrated fitness equipment stations in Kings Domain South and other suitable locations adjacent to the Tan Track.				
Review the service and use of the two maintenance depots to determine if both are still required.				

	<b>In partnership with the Victorian Arts Centre Trust, proposals relating to the management of the Sidney Myer Music Bowl include:</b>			
	Work in partnership with the Victorian Arts Centre Trust to adapt to contemporary trends in use at the Sidney Myer Music Bowl, while also respecting the importance of passive recreation in the adjacent parkland.			
	Conduct a strategic review of the interface with the Sidney Myer Music Bowl and Kings Domain.			
	Prepare a detailed landscape plan to improve the access to and interface with the Sidney Myer Music Bowl and to improve entries to the venue.			
	Work with the Victorian Arts Centre Trust in preparation of a master plan for the Sidney Myer Music Bowl to facilitate improvements and rationalisation of public amenities, toilets, lighting, storage, fencing, access and entrances, and where possible conceal infrastructure in the landscape.			
	Explore design and management improvements to vehicle (truck) entry to the 'back of house'.			
	Reduce and resolve the need and impact of temporary infrastructure on the landscape.			
	Realign the fencing near the toilets to improve pedestrian circulation.			
	Refine path layout in Kings Domain to improve access to the Sidney Myer Music Bowl. Improve path lighting for public safety.			
<b>Manage events</b>	Establish a Domain Parklands Event Program Group to discuss and coordinate the calendar of events across the Domain Parklands. <b>High priority initiative</b>			
	Develop a clear position to balance the use of the parkland for passive and event use and review the event sustainability guidelines. <b>High priority initiative</b>			
	Continue to seek a balanced approach to park and event management. <b>High priority initiative</b>			
	Investigate moving some fun run start / finish areas to locations where adequate infrastructure is already in place. <b>High priority initiative</b>			
	Initiate events curated more specifically for the Domain Parklands. <b>High priority initiative</b>			
	Where appropriate, relocate some events to the Sidney Myer Music Bowl. <b>High priority initiative</b>			

	Subject to and aligned with Victorian Government development on the north bank, investigate the location, purpose and need for a new bridge to improve pedestrian and bicycle accessibility across the Birrarung (Yarra River), and if supported to be funded by the Victorian Government.			
	Improve approach to F Gate at Melbourne Gardens at Dallas Brooks Drive and Birdwood Avenue.			
<b>Support access by public transport</b>	Advocate for substantial improvements to public transport to the Domain Parklands and destinations within it.			
	Work with the Land Managers and Metro Rail to provide a new accessible pedestrian path from Anzac station into the parklands and to the Birdwood Avenue entries to the Shrine of Remembrance and Melbourne Gardens.			
	Investigate future options for public transport, including autonomous vehicles.			
	Work with Parks Victoria to develop a strategic approach to the location and style of boat landings which will support visitor transport to parklands.			
<b>Network approaches to improve cycling routes</b>	Develop a network based solution to the points of conflict between cyclists and other parklands users, consistent with the Bicycle Plan 2016 – 2020..			
	Design and implement a dedicated cycle lane following the Birrarung (Yarra River) corridor along or adjacent to Alexandra Avenue (S) from Morell Bridge, to connect to new Linlithgow Avenue and Southbank Boulevard cycle lanes. <b>High priority initiative</b>			
<b>Contemporary way-finding in the Domain Parklands</b>	Using new and existing technologies develop and implement a comprehensive way-finding strategy for the Domain Parklands in consultation with the other Land Managers. This will include: <ul style="list-style-type: none"> <li>A framework for creating interpretive landscapes and signage with Traditional Owners.</li> <li>A staged approach to removal, installation and as well as maintenance guidelines.</li> <li>An interpretation plan to provide information about the Domain Parklands.</li> </ul> <b>High priority initiative</b>			
<b>Create journeys in the Domain Parklands</b>	Define and promote a variety of journeys for navigating through the parklands.			
	Develop and promote a Domain Parklands Walk, a River Walk, and a Botanical Walk.			
<b>Rethinking the use of existing road space</b>	Change the language and appearance of the roads to prioritise pedestrians and the parkland setting.			
	Introduce traffic calming measures on internal roads.			
	Trial temporary road closures for pedestrian and cycle use, and events on Linlithgow Avenue (S), and other internal roads where possible.			
	Reduce speed to 20km per hour on Boathouse Drive. <b>High priority initiative</b>			
	Create a new drop off / pick up / turning circle for cars at the east end of the boathouses. Restrict vehicle access along the front and back of the boathouses.			
	Establish a new shared zone behind the boathouses, to create a good alternative for cyclists and discourage commuter cycling from the front of the boathouses in the short term.			
	Undertake detailed design to install a bike path at Linlithgow Avenue while retaining vehicle access to Boathouse Drive.			
	Remove slip lane between Linlithgow Avenue and Linlithgow Avenue (S). Reinstate park in current road reserve and create accessible path link.			
	Investigate changes to Alexandra Park and Alexandra Avenue (S) to create a separated cycle lane.			
	Create drop off areas at Marquis of Linlithgow Reserve and at Observatory Gate and Shrine of Remembrance. While providing bus drop off / pick up adjacent to the Shrine of Remembrance, relocate bus parking to the park perimeter on St Kilda and Domain Roads.			
	Investigate closure of Linlithgow Avenue (S) to through traffic, to create generous shared path while maintaining access for service vehicles.			
	Review location of bus drop off and bus parking for Melbourne Gardens.			
	In the longer term, following completion of the Metro Tunnel project and subject to alternative options for pedestrian access, investigate closure of Birdwood Avenue (N) to through traffic, to create generous shared path while maintaining access for service vehicles.			
<b>Car parking– support</b>	Where appropriate and possible, repurpose car parks to reduce the width of road pavements and landscape to improve environmental services and amenity.			

Improve people movement and access

Initiatives	Action or Recommendation	Indicative timeline		
		Short	Medium	Long
<b>Improve parkland entrances</b>	Improve entrances: <ul style="list-style-type: none"> <li>At the major park entry at Linlithgow Avenue and St Kilda Road.</li> <li>At the tram stops along St Kilda Road and Domain Road. Improve access and wayfinding from all tram stops adjacent to the parklands.</li> <li>By designing a new accessible entry from the Coventry Street / Dorcas Street tram stops with the Shrine. Realign and reconstruct the stairs.</li> <li>At the Alexandra Gardens entry at St Kilda Road and the accessible path entry to Queen Victoria Gardens.</li> <li>To the rowing precinct and within the Birrarung (Yarra River) corridor.</li> </ul>			
	Work with the Royal Botanic Gardens to improve entries, in particular the Anderson Street entries (A Gate and C Gate).			
	Create accessible paths from the river landing to connect to a new Melbourne Gardens entry along Alexandra Avenue (S).			
	Create a pedestrian plaza and drop off zone at the Melbourne Observatory, to improve visitor arrival experience at these destinations and improve the interface with the Melbourne Gardens and Shrine of Remembrance. The detailed design will be prepared in partnership with the Royal Botanic Gardens Victoria and Shrine of Remembrance.			
<b>Improve internal pathway networks.</b>	Review the path network to identify a hierarchy of paths. <b>High priority initiative</b>			
	Identify and promote key routes for accessible paths of travel through the parklands. <b>High priority initiative</b>			
	Provide new paths, including new alignment to improve accessibility adjacent to the Birrarung. Create the 'River Walk' as part of this project. <b>High priority initiative</b>			
	Identify accessible paths of travel to the Sidney Myer Music Bowl through the parklands. Highlight these paths to patrons with in- ground lighting.			
<b>Reduce barriers and improve access over roads</b>	Investigate provision of a tree top walk and viewing area from the escarpment			
	Assess current visual and physical barriers and boundaries. Improve links and access by providing consistent and clear pedestrian crossings at regular intervals and key locations.			
	Explore opportunities to improve the connection between the Queen Victoria and Alexandra Gardens, such as a land bridge across Alexandra Avenue (N), and ways to reduce the impact of noise on the parkland visitors.			
	Provide an additional signalised pedestrian crossing over Alexandra Avenue (N).			

visitor access while adapting to future trends	Review and modify parking restrictions to ensure they reflect and support the needs of visitors to the Domain Parklands. Provide greater consistency in application of parking restrictions across the parklands.			
	In the short term, change all day parking to 4 hour parking in Linlithgow Avenue (S) to better support park visitors. <b>High priority initiative</b>			
	Install pedestrian priority crossings at regular intervals along Linlithgow Avenue (S) Birdwood Avenue, Dallas Brooks Drive and Alexandra Avenue (S).			
	Work with the Melbourne Garden to improve the pedestrian crossing on Dallas Brooks Drive (N).			
	Review location and quantity of drop off bays, bus parking, accessible parking and taxi, food vendor and horse carriage bays. Increase accessible parking at key destinations.			
	Repurpose car parking spaces in Linlithgow Avenue to provide dedicated bicycle lanes. <b>High priority initiative</b>			
	Modify parking restrictions on St Kilda Road at the Alexandra Gardens entry to support a drop off / pick up area for rowers.			
Work with Land Managers to minimise the parking of cars on the landscape.				

#### Management and partnerships to build resilience

Initiatives	Action or Recommendation	Indicative timeline		
		Short	Medium	Long
<b>Make one parkland of many unique destinations</b>	In addition to the proposals to improve pedestrian access and environmental services, 'making one parkland of many unique destinations' will be strengthened by establishing an agreed vision for the Domain Parklands with all Land Managers. <i>This action recognises that there are distinct organisational visions and profiles for each Land Manager (and their organisation), as well as specific legislation directing their purpose.</i>			
<b>Create a framework for priorities and decision-making</b>	Develop an implementation plan for the master plan which clearly articulates short, medium and long term actions to logically implement the master plan actions. <b>High priority initiative</b> Review and update the master plan 10 years after it is endorsed by Council.			
<b>Commitment to future management and collaboration</b>	Initiate regular meetings of the Land Manager executives. Introduce regular meetings for operational staff to examine visitor requirements to inform planning for improved services. Explore shared use provision of some visitor services.			
<b>Managing uses in the Crown reserves managed by the City of Melbourne</b>	Continue and improve (as required) the management practices developed by the City of Melbourne with Department of Environment Land Water and Planning to assess uses inconsistent with the parklands reservations.	Ongoing		
<b>Reduce the impact of services</b>	<b>Management approach</b> Protect the landscape character of the Domain Parklands by avoiding new or expansion of existing above ground utility structures associated with electricity, gas or telecommunications. Seek opportunities to work with Land Managers to reduce duplication of services, ensure infrastructure is discrete and consolidated. Address the negative visual impact of service cabinets on St Kilda Road boundary of Queen Victoria Gardens and other services in the parklands. Review the potential to provide more permanent telecommunications support within existing infrastructure.	Ongoing		





### How to contact us

**Online:**

[melbourne.vic.gov.au](http://melbourne.vic.gov.au)

**In person:**

Melbourne Town Hall - Administration Building  
120 Swanston Street, Melbourne  
7.30am to 5pm, Monday to Friday  
(Public holidays excluded)

**Telephone:**

03 9658 9658  
7.30am to 6pm, Monday to Friday  
(Public holidays excluded)

**Fax:**

03 9654 4854

**In writing:**

City of Melbourne  
GPO Box 1603  
Melbourne VIC 3001  
Australia

 **Interpreter services**

We cater for people of all backgrounds  
Please call 03 9280 0726

- 03 9280 0716 አማርኛ
- 03 9280 0717 廣東話
- 03 9280 0718 Ελληνικά
- 03 9280 0719 Bahasa Indonesia
- 03 9280 0720 Italiano
- 03 9280 0721 國語
- 03 9280 0722 Soomaali
- 03 9280 0723 Español
- 03 9280 0724 Türkçe
- 03 9280 0725 Việt Ngữ
- 03 9280 0726 All other languages

**National Relay Service:**

If you are deaf, hearing impaired or speech-impaired, call us via the National Relay Service: Teletypewriter (TTY) users phone 1300 555 727 then ask for 03 9658 9658 9am to 5pm, Monday to Friday (Public holidays excluded)

[melbourne.vic.gov.au](http://melbourne.vic.gov.au)



CITY OF MELBOURNE