

LONSDALE STREET GREEK PRECINCT GREENING

Construction update

April 2022

City of Melbourne is creating an inviting and functional space on Lonsdale Street with new café screen planter boxes and an improved footpath.

This project will enhance the visual appearance of the area and provide an open space for traders to set up dining facilities.

The works will begin mid-May 2022 and are expected to finish late July 2022.

The street upgrades will include:

- removal of five existing café shelters
- repaired broken bluestone pavers
- reinstated Hellenic Greek edge stone pavers
- permeable paving system around tree bases
- stainless steel planter boxes with lush greenery
- new irrigation systems for the planters.

Timing and impacts

The works will be between Russell Street and Tattersalls Lane. A fencing and cage compound will be in place around the work area.

Access to residential properties and businesses will be maintained at all times, however the footpath will be narrowed for the duration of the works.

Normal construction hours will be 5.30am to 4pm Monday to Friday. Occasional night works may be required.

Disruptions



Noise

Saw cutting and jackhammering will occur during work hours.



Loading zones

The construction area will intrude on the roadway and loading zones. Traders will need to use alternative loading zones while works are underway.

Nearby residents and traders will be notified of disruptions ahead of works commencing.



A render of the café screen planter boxes

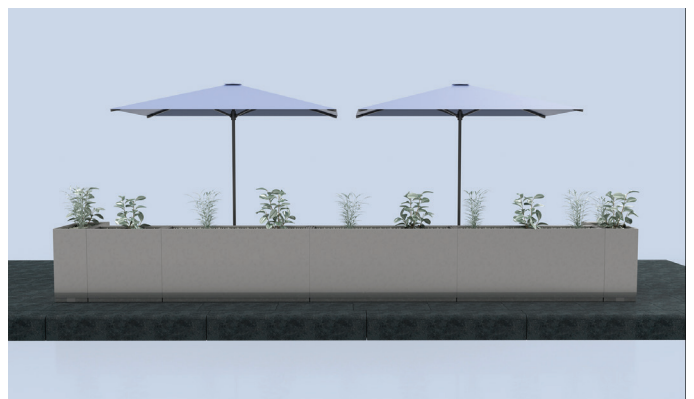

A street view render of the café screen planter boxes

To find out more, please contact **9658 9658** or visit melbourne.vic.gov.au/cityprojects